

Soluciones en tubo rígido y flexible

Corrugado LH

Rígido LH

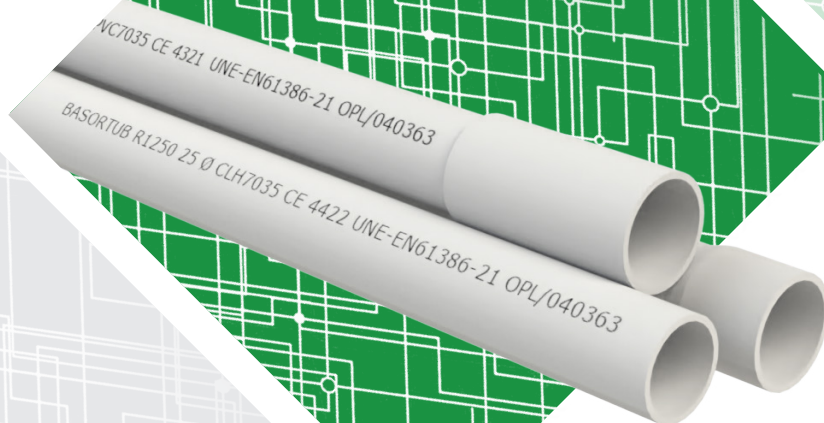
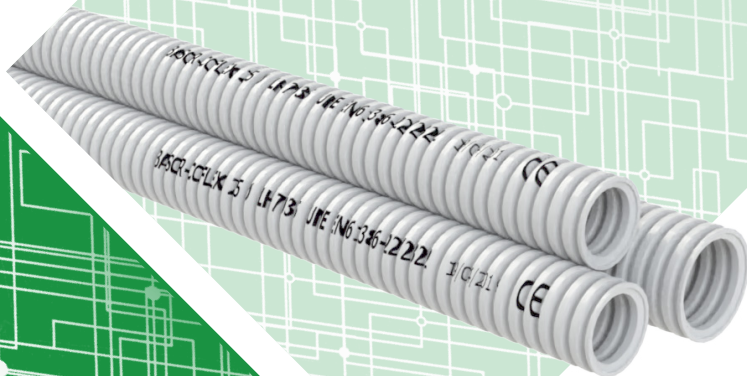

Basortub



3E Basor
CABLE TRAY SPECIALIST

TUBO RÍGIDO ABOCARDADO LIBRE DE HALÓGENOS RE1250 RLH

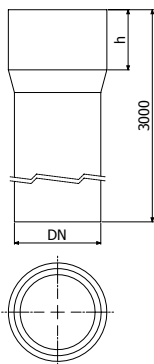

| | DN | | RLH 7035 | | |
|-----------|----|----|----------|------------|------------|
| | mm | mm | REF. | Paquete(m) | Pallet (m) |
| RE1250 16 | 16 | 14 | 2/6453 | 114 | 3.990 |
| RE1250 20 | 20 | 16 | 2/6454 | 57 | 2.565 |
| RE1250 25 | 25 | 20 | 2/6455 | 57 | 1.824 |
| RE1250 32 | 32 | 22 | 2/6456 | 30 | 1.050 |
| RE1250 40 | 40 | 26 | 2/6457 | 15 | 720 |
| RE1250 50 | 50 | 31 | 2/6458 | 15 | 525 |
| RE1250 63 | 63 | 60 | 2/6459 | 15 | 270 |



Tubo rígido según: **UNE-EN 61386-21 Cod.4322**. No propagador de la llama: **V2 según Norma UL94**
 Libre de halógenos **<0,07% UNE-EN 50642**. Rango de temperatura: **-5°C a +90°C**. Grado de protección **IP:54**;
IK:07. Resistencia al impacto **2J**. Alta resistencia a la compresión: **1250N**.

MANGUITO DE UNIÓN JUR1250



| | DN | | L | IP | RLH 7035 | | |
|------------|----|-----|----|--------|----------|-------------|------------|
| | mm | mm | | | REF. | Bolsa (uds) | Caja (uds) |
| JUR1250 16 | 16 | 50 | 40 | 2/6732 | 40 | 240 | |
| JUR1250 20 | 20 | 55 | 40 | 2/6733 | 20 | 240 | |
| JUR1250 25 | 25 | 60 | 40 | 2/6734 | 20 | 140 | |
| JUR1250 32 | 32 | 70 | 40 | 2/6735 | 10 | 50 | |
| JUR1250 40 | 40 | 80 | 40 | 2/6736 | 8 | 48 | |
| JUR1250 50 | 50 | 90 | 40 | 2/6737 | - | 16 | |
| JUR1250 63 | 63 | 130 | 40 | 2/6738 | - | 10 | |

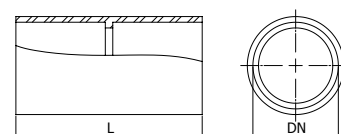

CURVA PLANA 90° CPR



| | DN | | R | IP | RLH 7035 | | PVC 7035 | |
|--------|----|-----|----|--------|----------|------------|----------|------------|
| | mm | mm | | | REF. | Caja (uds) | REF. | Caja (uds) |
| CPR 16 | 16 | 54 | 40 | 2/6739 | 50 | 2/18790 | 50 | |
| CPR 20 | 20 | 67 | 40 | 2/6740 | 50 | 2/18791 | 50 | |
| CPR 25 | 25 | 85 | 40 | 2/6741 | 25 | 2/18792 | 25 | |
| CPR 32 | 32 | 110 | 40 | 2/6742 | 25 | 2/18793 | 25 | |
| CPR 40 | 40 | 138 | 40 | 2/6743 | 15 | 2/18794 | 15 | |
| CPR 50 | 50 | 172 | 40 | 2/6744 | 5 | 2/18795 | 5 | |

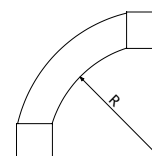

CURVA FLEXIBLE CFR



| | DN | | L | IP | RLH 7035 | | |
|--------|----|-----|----|--------|----------|-------------|------------|
| | mm | mm | | | REF. | Bolsa (uds) | Caja (uds) |
| CFR 16 | 16 | 220 | 65 | 2/6819 | 10 | 40 | |
| CFR 20 | 20 | 230 | 65 | 2/6820 | 10 | 150 | |
| CFR 25 | 25 | 540 | 65 | 2/6821 | 5 | 85 | |
| CFR 32 | 32 | 270 | 65 | 2/6822 | - | 20 | |
| CFR 40 | 40 | 300 | 65 | 2/6823 | 5 | 35 | |
| CFR 50 | 50 | 340 | 65 | 2/6824 | 10 | 20 | |

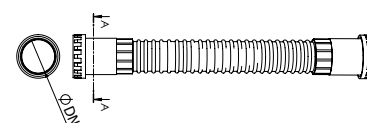

MANGUITO MCR1250



| | DN | L | A | IP | RLH 7035 | | |
|------------|----|----|----|----|----------|-------------|------------|
| | mm | mm | mm | | REF. | Bolsa (uds) | Caja (uds) |
| MCR1250 16 | 16 | 15 | 42 | 67 | 2/6746 | 25 | 500 |
| MCR1250 20 | 20 | 15 | 44 | 67 | 2/6747 | 25 | 600 |
| MCR1250 25 | 25 | 15 | 47 | 67 | 2/6748 | 25 | 400 |
| MCR1250 32 | 32 | 16 | 52 | 67 | 2/6749 | 15 | 210 |
| MCR1250 40 | 40 | 16 | 64 | 67 | 2/6750 | 10 | 100 |
| MCR1250 50 | 50 | 18 | 72 | 67 | 2/6751 | 5 | 70 |

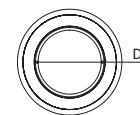
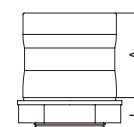
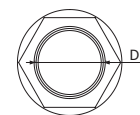

SOPORTE SPR1250

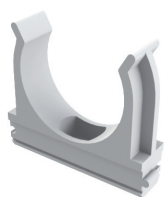

| | DN | A | B | C | RLH 7035 | | |
|------------|----|----|----|----|----------|-------------|------------|
| | mm | mm | mm | mm | REF. | Bolsa (uds) | Caja (uds) |
| SPR1250 16 | 16 | 12 | 25 | 21 | 2/6753 | 100 | 1.000 |
| SPR1250 20 | 20 | 12 | 28 | 26 | 2/6754 | 100 | 500 |
| SPR1250 25 | 25 | 12 | 32 | 31 | 2/6755 | 100 | 2.000 |
| SPR1250 32 | 32 | 12 | 43 | 44 | 2/6756 | 50 | 300 |
| SPR1250 40 | 40 | 14 | 50 | 52 | 2/6757 | 50 | 600 |
| SPR1250 50 | 50 | 14 | 56 | 62 | 2/6758 | 25 | 500 |

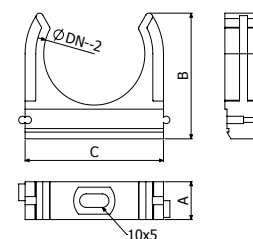

ABRAZADERA ABR 1250



| | DN | F | RLH 7035 | | |
|---------------|-------|----|----------|-------------|------------|
| | mm | kg | REF. | Bolsa (uds) | Caja (uds) |
| ABR1250 16-32 | 16/32 | 15 | 2/6760 | 50 | 2.000 |
| ABR1250 20-63 | 20/63 | 15 | 2/6761 | 100 | 1.000 |

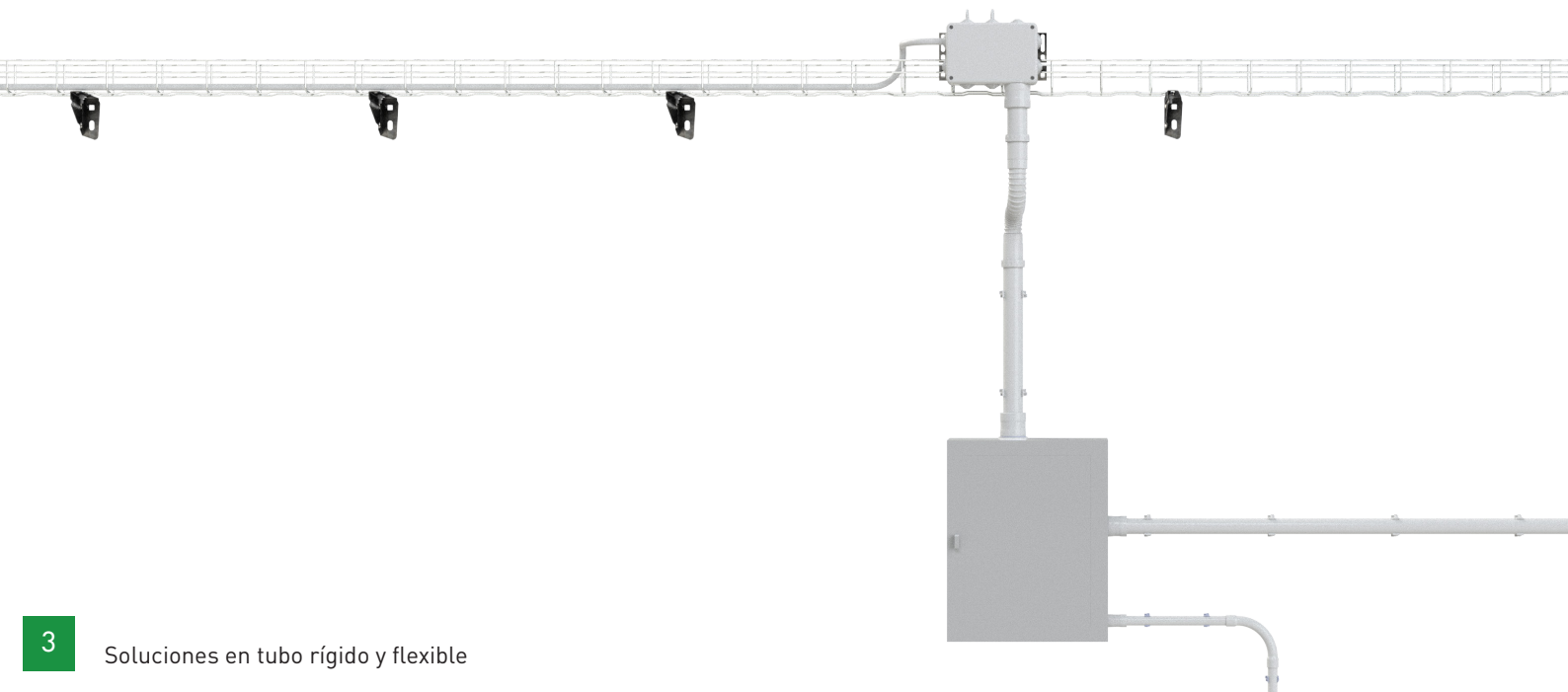
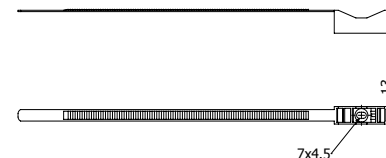

COFLEX



| | Dext | Dint | L | RLH 7035 | | |
|-----------|------|------|-----|----------|-----------|------------|
| | mm | mm | | REF. | Rollo (m) | Pallet (m) |
| COFLEX 16 | 16 | 11 | 100 | 2/6995 | 100 | 7.000 |
| COFLEX 20 | 20 | 15 | 100 | 2/6996 | 100 | 4.800 |
| COFLEX 25 | 25 | 20 | 75 | 2/6997 | 75 | 3.300 |
| COFLEX 32 | 32 | 27 | 50 | 2/6998 | 50 | 2.200 |
| COFLEX 40 | 40 | 34 | 25 | 2/6999 | 25 | 1.200 |
| COFLEX 50 | 50 | 44 | 25 | 2/7000 | 25 | 800 |

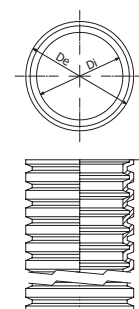

Tubo corrugado curvable según: **UNE-EN 61386-23 Cod.2322**. No propagador de la llama. Libre de halógenos según: **<0,4% UNE-EN 50642**. Rango de temperatura: **-5°C a +90°C**. Resistencia al impacto **2J**. Resistencia a la compresión: **390N**.

MANGUITO MCR1250



| | DN | L | A | IP | RLH 7035 | | |
|------------|----|----|----|----|----------|-------------|------------|
| | mm | mm | mm | | REF. | Bolsa (uds) | Caja (uds) |
| MCR1250 16 | 16 | 15 | 42 | 67 | 2/6746 | 25 | 500 |
| MCR1250 20 | 20 | 15 | 44 | 67 | 2/6747 | 25 | 600 |
| MCR1250 25 | 25 | 15 | 47 | 67 | 2/6748 | 25 | 400 |
| MCR1250 32 | 32 | 16 | 52 | 67 | 2/6749 | 15 | 210 |
| MCR1250 40 | 40 | 16 | 64 | 67 | 2/6750 | 10 | 100 |
| MCR1250 50 | 50 | 18 | 72 | 67 | 2/6751 | 5 | 70 |

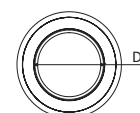
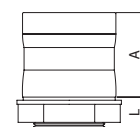
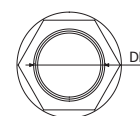
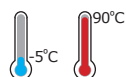

SOPORTE SPR1250



| | DN | A | B | C | RLH 7035 | | |
|------------|----|----|----|----|----------|-------------|------------|
| | mm | mm | mm | mm | REF. | Bolsa (uds) | Caja (uds) |
| SPR1250 16 | 16 | 12 | 25 | 21 | 2/6753 | 100 | 1.000 |
| SPR1250 20 | 20 | 12 | 28 | 26 | 2/6754 | 100 | 500 |
| SPR1250 25 | 25 | 12 | 32 | 31 | 2/6755 | 100 | 2.000 |
| SPR1250 32 | 32 | 12 | 43 | 44 | 2/6756 | 50 | 300 |
| SPR1250 40 | 40 | 14 | 50 | 52 | 2/6757 | 50 | 600 |
| SPR1250 50 | 50 | 14 | 56 | 62 | 2/6758 | 25 | 500 |

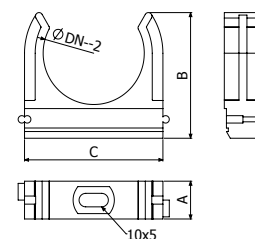
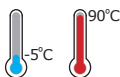

BRAZADERA ABR1250



| | DN | F | RLH 7035 | | |
|---------------|-------|----|----------|-------------|------------|
| | mm | kg | REF. | Bolsa (uds) | Caja (uds) |
| ABR1250 16-32 | 16/32 | 15 | 2/6760 | 50 | 2.000 |
| ABR1250 20-63 | 20/63 | 15 | 2/6761 | 100 | 1.000 |

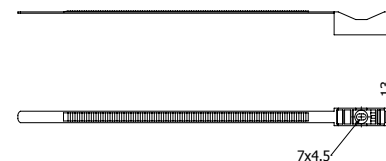
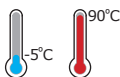

BE Basor

CABLE TRAY SPECIALIST



Basor Electric S.A
Avenida Alcodar 45-47
Gandia (Valencia)
Tel.96.287.6695



LinkedIn
Basor Electric S.A



Twitter
@Basorelectric



Youtube
youtube.com/user/basorelectric



Web
www.basor.com